

## Dock Related Measurements

### NORTH BUILDING

#### East Freight Elevators

|             |                  |
|-------------|------------------|
| Max Weight  | 10,000 lbs.      |
| Width       | 11 feet 8 inches |
| Depth       | 13 feet 6 inches |
| Height      | 12 feet          |
| Open Access | 8 feet 6 inches  |

#### West Freight Elevators

|             |                  |
|-------------|------------------|
| Max Weight  | 10,000 lbs.      |
| Width       | 8 feet 6 inches  |
| Depth       | 23 feet 6 inches |
| Height      | 12 feet          |
| Open Access | 8 feet 6 inches  |

#### West Ramp

|        |                 |
|--------|-----------------|
| Width  | 24 feet         |
| Grade  | 7%              |
| Canopy | 3 feet 9 inches |

#### West Ramp Door

|        |                  |
|--------|------------------|
| Width  | 24 feet          |
| Height | 13 feet 9 inches |

### SOUTH BUILDING

#### Truck Elevators (60,000 lbs.)

|        |                  |
|--------|------------------|
| Length | 38 feet          |
| Height | 13 feet 6 inches |
| Width  | 12 feet          |

#### Entrance from Truck Elevator Service Corridor to PF Area on 600 & 700 Level

|        |                 |
|--------|-----------------|
| Height | 7 feet 5 inches |
| Width  | 9 feet 9 inches |

#### Roll up door into Hall G

|        |                  |
|--------|------------------|
| Height | 15 feet 4 inches |
| Width  | 16 feet          |

### SOUTH LOADING DOCKS

#### South ramp (top to bottom)

Length 710 feet

#### South ramp (inside curb to curb)

Width 24 feet 9 inches

#### Roll up door at top of South ramp

Height 20 feet 8 inches

#### Roll up door into Hall D & E

Height 15 feet 9 inches

#### Each dock

Width 8 feet 3 inches

#### Dock lift mechanism

Width 6 feet 2 inches

#### West ramp

|        |                  |
|--------|------------------|
| Width  | 21 feet 7 inches |
| Length | 65 feet 9 inches |

#### East ramp

|        |                  |
|--------|------------------|
| Width  | 24 feet 9 inches |
| Length | 8 feet 8 inches  |

### BREMNER SERVICE ELEVATORS

|            |                 |
|------------|-----------------|
| Max Weight | 5,000 lbs.      |
| Length     | 8 feet 4 inches |
| Height     | 7 feet          |
| Width      | 4 feet 6 inches |

#### Door Specs

#### Bremner Blvd. Entrance:

##### Double Glass Doors

|        |                  |
|--------|------------------|
| Height | 7 feet 8 inches  |
| Width  | 5 feet 10 inches |

##### Parking Door

|        |                  |
|--------|------------------|
| Height | 6 feet 10 inches |
| Width  | 5 feet 10 inches |

##### 600 Level

|        |                  |
|--------|------------------|
| Height | 6 feet 9 inches  |
| Width  | 2 feet 10 inches |

#### 700 Level

|        |                  |
|--------|------------------|
| Height | 6 feet 10 inches |
| Width  | 5 feet 10 inches |

#### 800 Level:

##### Hall E

|        |                  |
|--------|------------------|
| Height | 7 feet 2 inches  |
| Width  | 3 feet 10 inches |



##### Hall F

|        |                  |
|--------|------------------|
| Height | 6 feet 10 inches |
| Width  | 5 feet 10 inches |

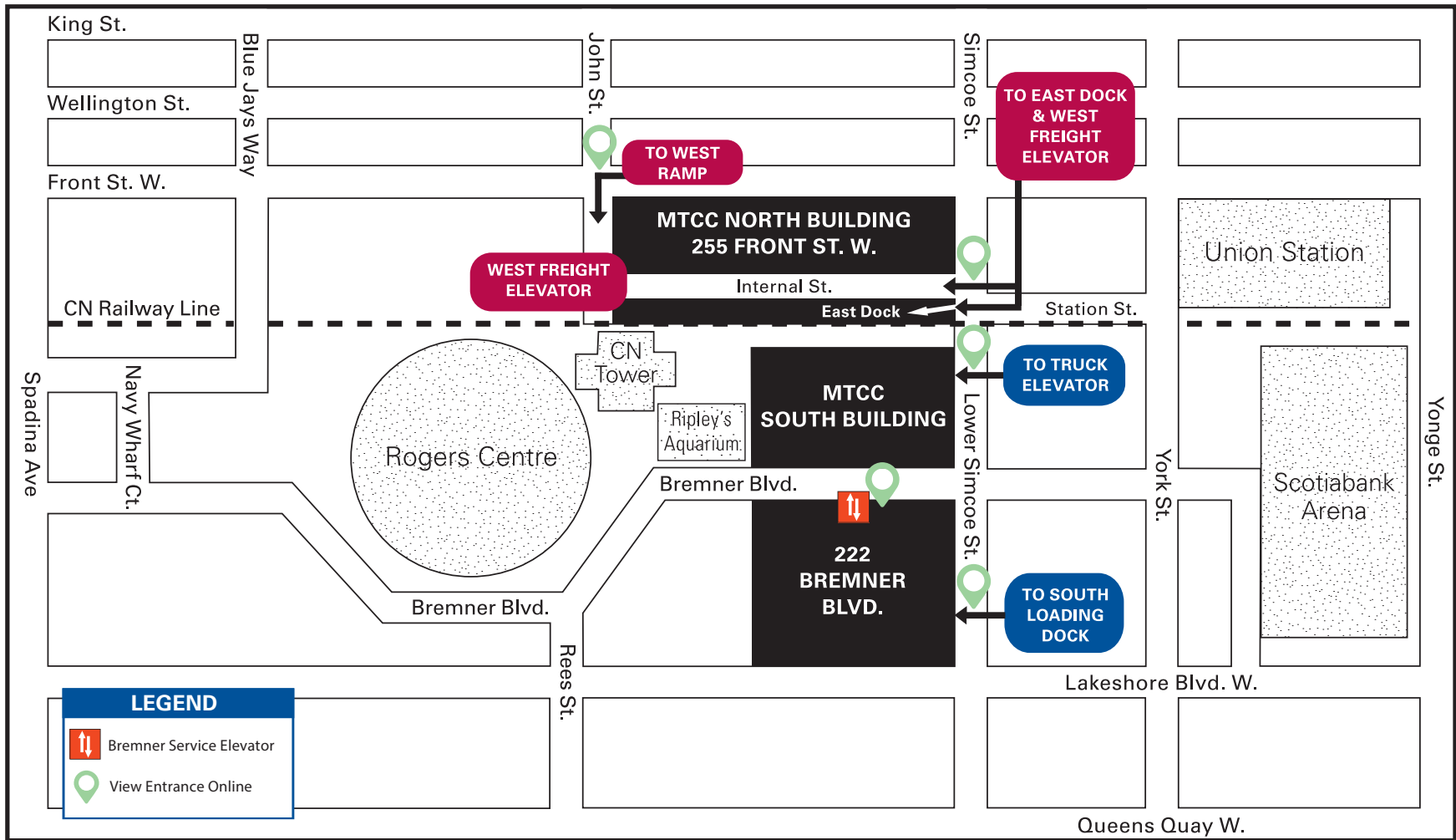
# Loading Dock Map



**LEGEND**

-  Bremner Service Elevator
-  View Entrance Online

N  
Map is not to scale

01|21